

D100



Model D100 Controller

For more than 30 years Control Gaging Inc. has responded to the diverse needs of the machining industry with innovative gaging solutions that have gained us international respect.

As America's leading supplier of in-process gaging systems we do not rest idle on our accomplishments. We continue to develop and patent innovative gaging solutions to improve our customers' process control and out-perform our competitors.

In keeping with our tradition of innovation, Control Gaging is pleased to announce the introduction of the D100 Gage Controller. The D100 Controller employs state-of-the-art DSP technology to deliver unmatched performance from a small, single circuit board design.

Control Gaging believes that you should never have to sacrifice durability for performance so we have designed the D100 to withstand today's factory environments and we back it up with the industries only three year warranty.



- **Easy-to-use**
- **Three Year Warranty**
- **ID/OD Operation**
- **Smooth or Interrupted Surfaces**
- **Metric/Inch Analog Meter**
- **Four Setpoint Outputs**
- **Proportional Analog Output**
- **Single button size adjustments**
- **Remote Zeroing**
- **Remote Size Offset**
- **2440 Readings/sec**
- **RoHS Compliant**

The D100 controls wheelslide infeed based on real-time workpiece size using one transducer or can use two transducers in an "A + B" configuration.. The D100 comes equipped with four 24 Vdc programmable setpoint outputs, proportional analog output and can be used for OD or ID applications. The D100 also includes electronic filtering for measuring part surfaces with interruptions. Size adjustments are made with the push of a single button on the front panel or by a remote mounted switch.

The D100 is available in two different chassis configurations; stand-alone or panel-mount.

TAKE CONTROL & SAVE MONEY

Control Gaging Incorporated

5200 Venture Dr. Ann Arbor, Michigan 48108
www.controlgaging.com

Phone: +1 734.668.6750 Fax: +1 734.994.1335
Email: sales@controlgaging.com

D100



Standard Chassis

Ref. Drawing D900930D-001

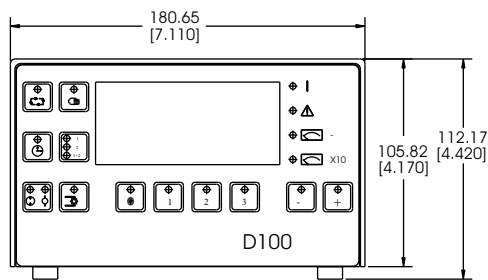

FRONT VIEW

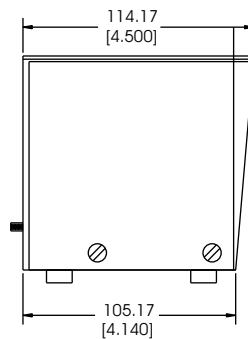

LEFT SIDE VIEW

General Specifications

Weight: 1kg. (2.2 lbs.)

Chassis: IP54

Power: 100-240V ac
50/60 Hz
4W

Inputs: 20-30V dc

Setpoint: 24V dc
Outputs: 125 mA max.

Analog: +/- 10V dc
Output: Proportional

Panel Mount Chassis

Ref. Drawing D900930D-002

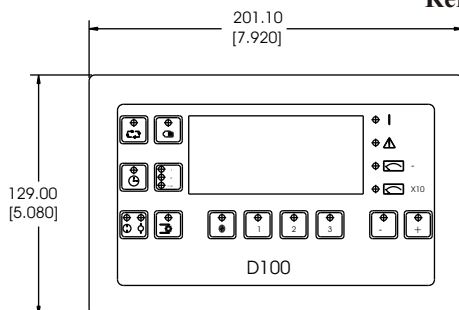

FRONT

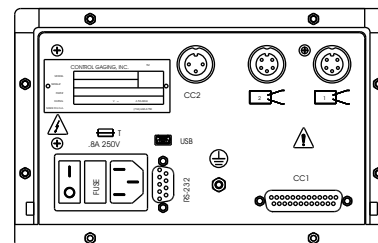

REAR

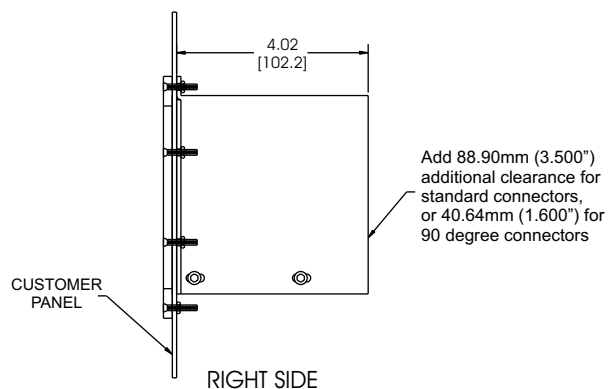

RIGHT SIDE

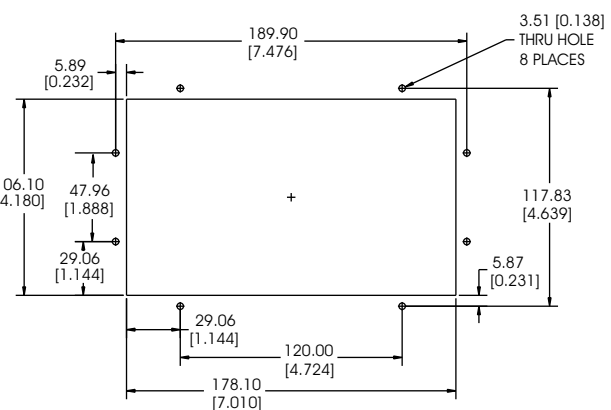

PANEL CUTOUT

TAKE CONTROL & SAVE MONEY

Control Gaging Incorporated

5200 Venture Dr. Ann Arbor, Michigan 48108
www.controlgaging.com

Phone: +1 734.668.6750 Fax: +1 734.994.1335
Email: sales@controlgaging.com